

Slide on &
slip away



Frontier
**back
pack**
BY explorer motorhomes

Expertly designed
and built in
New Zealand at the
home of Explorer
Motorhomes

The Frontier Backpack is designed
and manufactured in Auckland.

FULL ALUMINIUM BODY

The Backpack is constructed using
an aluminium frame and clad with
aluminium composite material
(ACM) which has a polyethylene
core sandwiched between two
aluminium sheets. It is light in weight
yet exhibits excellent flatness and
stiffness, making it ideal for the
Backpack's body. We add wall and
ceiling insulation between the ACM
skin and interior wall linings for extra
seasonal comfort.

WILL THE FRONTIER BACKPACK FIT YOUR UTE?

The Backpack has been designed
around the Ford Ranger and Mazda
BT50 double cab because we
exclusively use these two models for
our Explorer motorhomes. Backpack
will fit on some other double cab
utes too. If you have an alternative
make, we can let you know if it will be
suitable. We recommend a simple
suspension upgrade to assist with
the increased load on all utes used.

QUALITY, QUALITY, QUALITY

Every Frontier Backpack is built
with the same attention to detail
and quality that we lavish on our
Explorer motorhomes. Quality
is everything to us. We only use
industry-leading components that
we know will last the distance. We
know that your Frontier Backpack
is going to take you to some pretty
exciting places, so everything needs
to work and last.

Frontier Backpack

Turn your workday double cab ute into a holiday
motorhome by simply sliding on a Frontier
Backpack. Slip away into the wilds of New Zealand
knowing you have everything you need to take
time out in comfort.

Frontier Backpack gives you the best
of both worlds; a double cab ute
through the week for work and when
the weekends and holidays roll round,
transform it into your go-anywhere
adventure machine in under 30 minutes.

At 6.2 metres long x 2 metres wide
on the double cab Ford Ranger or
Mazda BT50, Backpack is compact
and easy to drive and park. Stand your
Backpack on it's own legs when you
get where you want to be or keep
it comfortably on the back. Frontier
Backpack gives you more options
than your average motorhome.

Backpack may not be huge but it's
certainly cleverly designed and provides
owners with the necessary comforts.

A great night's sleep is essential when
you're on holiday so the Backpack's
class-leading permanent north-south
bed in the luton is superb. It's bigger
than a double, measuring 1400mm
wide x 2000mm. It's an airy and
generous relaxing and sleeping space
with sitting headroom and easy
step-up access from the couch.

Opening windows at each side of the
bed with built-in insect screens, offer
good views and ventilation.

If you're accommodating four, you
can even convert the rear dinette into
another bed for two.

But you can't sleep for too long; there's
just too much to see and do in our

incredible country. Sit up high in the
comfort of the dinette lounge and take
in the views morning, noon and night.

Backpack's galley features a
combination stainless steel sink with
flush-mounting glass lid, folding hot
and cold tap and 2-burner gas hob.
There's also a 64 litre fridge/freezer
(12V) and enough storage for your
kitchen stores and equipment.

Gas and power from the 150 watt solar
panel mean you've certainly got
everything you need to take care of
yourself wherever you may be.
Efficient LED fittings provide effective
lighting in all areas.

Backpack has fresh water capacity of
70 litres onboard and grey water
capacity of 50 litres using a rollaway
tank. Backpack is Certified Self
Contained too.

We only use high quality lightweight
plywood joinery for the onboard
joinery. The white laminate finish
provides a practical and hard wearing
finish. We don't use MDF laminate
products as they are easily damaged
and swell if they get wet. There's good
storage in the cupboards, bedside
lockers, full-height wardrobe and the
space under the dinette seating.

You won't go without other creature
comforts in this slide-on camper either.
There's a hot/cold single lever tap
shower with extension shower hose
on a slide rail as well as the Thetford

**Frontier
back
pack**
BY explorer motorhomes



NEW ZEALAND'S OWN PRODUCTION SLIDE-ON MOTORHOME

The perfect lifestyle
accessory for your
double cab ute



COMPACT & EASY TO DRIVE

The perfect size to
park and manoeuvre



FULLY EQUIPPED

Four berths, galley,
shower and toilet
all self-contained
for comfortable
breaks away



BUILT HERE WITH PRIDE

Built tough for
New Zealand conditions.
Full service and
backup from
Explorer Motorhomes



cassette system pivoting toilet in Backpack's bathroom.

Frontier Backpack is waiting for you and your double cab ute to pick it up and head off for the time of your life. Back up your busy life and hit the road with your very own Backpack.



ABOVE: Backpack's generous permanent luton bed and dinette lounge area are the perfect places to relax in comfort.

LEFT BELOW: Integrated gas hobs and sink, fridge and storage makes for a compact and functional galley.

BELOW: Backpack's bathroom with pivoting toilet and shower is well ventilated through the roof vent.



BACKPACK FLOORPLAN

DAY

NIGHT

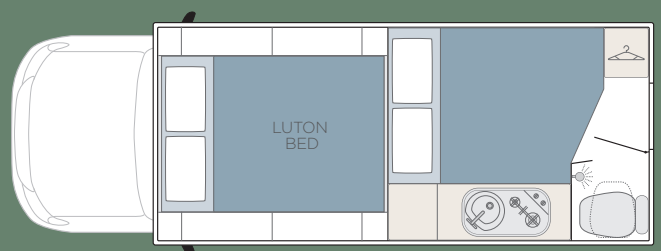
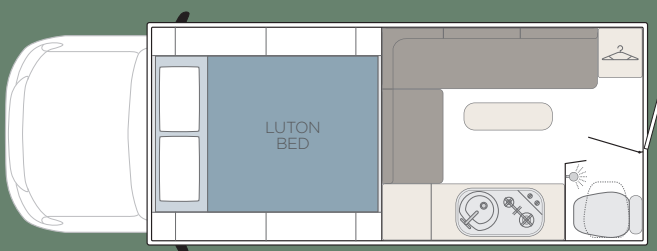

Frontier Backpack Standard Specifications

Options & Accessories

DIMENSIONS (METRES)		GALLEY	
Overall external length	4.5m	Sink/Hob: Integrated combination 2 burners LPG cooker, sink and tap. Stainless steel with folding tap and flush-mounting glass lid	Awning
External width	2.0m	Fridge: 64 litre Waeco with freezer compartment (12V)	Reversing Camera
External height (excluding satellite dish, if fitted)	2.95m	Benchtop: Formica	Clearview extendable & foldable Power Mirrors
Internal head height	1.88m	Interior Joinery: Laminate on plywood (not MDF) incl. drawer & lockers	LCD TV with wall bracket
External length on Ford Ranger/Mazda BT50 double cab ute	6.2m	Ventilation: Roof vent	Satellite Dish
TANKAGE		BATHROOM	LPG Heater
Fresh water tank (with Tank Monitor)	75L	Shower: Hot/cold water flexible pull-up shower on slide rail	Radio / CD / Auxilliary Player Head with stereo speakers
Grey water tank (portable)	50L	Toilet: Thetford C200 Swivel 17 litre tank	Drying Rack in bathroom
LPG Bottle	4kg	Lighting: LED	Galley 12V Ventilation Fan
LIVING		Ventilation: Roof vent with insect screen	Extended Tow Bar
Dinette Upholstered Seating: choose from a selection of fabrics		ELECTRICAL	
Removable Table with stowable leg: 250mm x 800 mm		Lighting: LED (12V)	Suspension Upgrade
Flooring: Vinyl		150kw Solar Panel with regulator	
Lighting: LED ceiling		House Battery: 130 amp hour AGM sealed deep cycle	
Roof Vent / Skylight: 400mm x 400mm with insect screen		Battery Monitor: BEP	
Wardrobe: Full height		Water Heater: Truma 14 litres (LPG)	
Storage: Lockers under dinette seating		SAFETY	
SLEEPING		Entry Handrail with security feature	
Bed (luton): 1.4m x 2.0m		Gas Detector	
Bed (dinette): 1.35m x 1.88m		Fire Extinguisher	
LED lighting each side		EXTERIOR	
Privacy curtain		ACM Body on aluminium frame	
Double-glazed acrylic windows with integrated blind & insect screen & telescopic arms, each side		Door: Two-part with security flyscreen door	
Storage: Lockers each side of bed		Windows: Double-glazed acrylic with integrated roller screens & insect screen & telescopic arms	
COMPLIANCE		Exterior Entrance Step	
Certified Self Contained		Exterior LED Light	



Reversing camera



Clearview extendable and foldable power mirrors



Radio / CD / Auxilliary Player Head with stereo speakers



Drying rack



Galley 12V ventilation fan



**Frontier
back
pack**
BY explorer motorhomes

Explorer Motorhomes Limited
Factory: 174 Green Road, RD2 Albany, Auckland 0792
Postal: 118 O'Brien Road, Coatesville, RD3 Albany,
Auckland 0793, New Zealand

info@explorermotorhomes.co.nz
09 447 1442 / 0800 227 144
explorermotorhomes.co.nz